

SOLD



17 Fitzroy Street, Junee

This ultimate package offers so much value only walking distance to the main street and aquatic centre. Positioned on a 500m2 block, this ultimate package provides a great lifestyle for those entering the market or those seeking a luxurious downsizer.

The floorplan works perfectly with a generous entry which works well as a home office. The master suite features size plus a reverse cycle system, walk in robe and ensuite.

The internal timber trims and doors offer a warmth to the interior that will excite. You will be excited as you enter the main living zone incorporating kitchen, meals and dining.

Ample natural light beam through with exterior door to enter the front and back verandah....

Reverse cycle split s...

4 2 2

Price: Undisclosed

View: <https://remaxvision.com.au/7010934>

Jenna Pollard

M 0418 421 621



Jacqui Hedlund
0416 243 257



Narrabeen

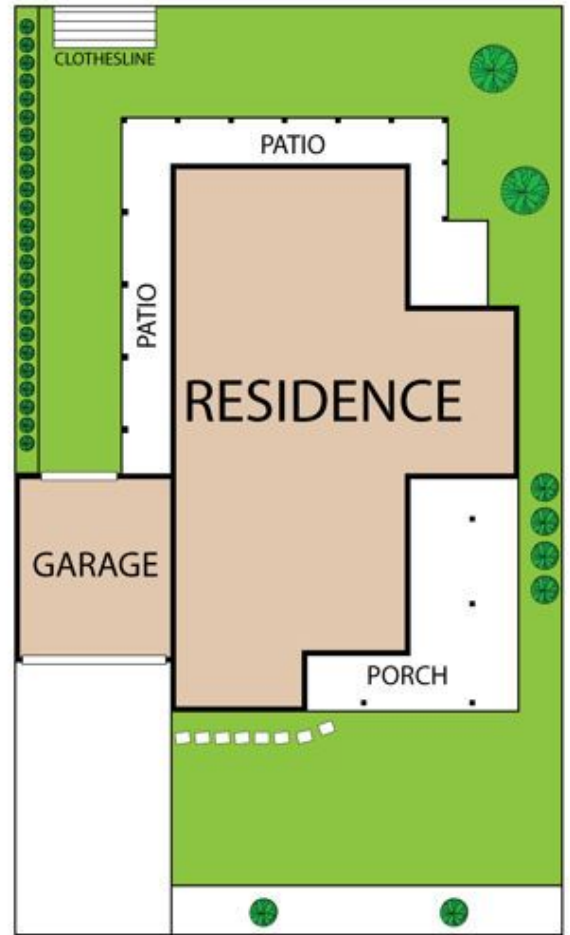

17 Fitzroy Street, Junee 2663

TOTAL APPROX. FLOOR AREA 154 SQM

Whilst every attempt has been made to ensure the accuracy of the floor plan contained here, measurements of doors, windows, rooms and any other items are approximate and no responsibility is taken for any error, omission, or misstatement. This plan is for illustrative purposes only and should be used as such by any prospective purchaser.