

SOLD



10 Anzac Avenue, Junee

A family favourite positioned in one of Junee's premium positions is a real showstopper with so much to offer. A much loved family residence, you will enjoy expansive living zones incorporating a formal lounge room, kitchen, dining and separate family room.

A floor plan that will excite the active family with 4 bedrooms on the upper level plus an additional two rooms with internal access on the lower level.

The kitchen is the ultimate with an abundance of cabinetry and preparation space plus dishwasher, gas cooking and an elevated outlook.

Features that will excite include electric shutters throughout, ducted evaporative cooling...

4 2 2

Price: Undisclosed

View: <https://remaxvision.com.au/7114932>

Jacqui Hedlund

M 0416 243 257



Jenna Pollard
0418 421 621



Narrabeen

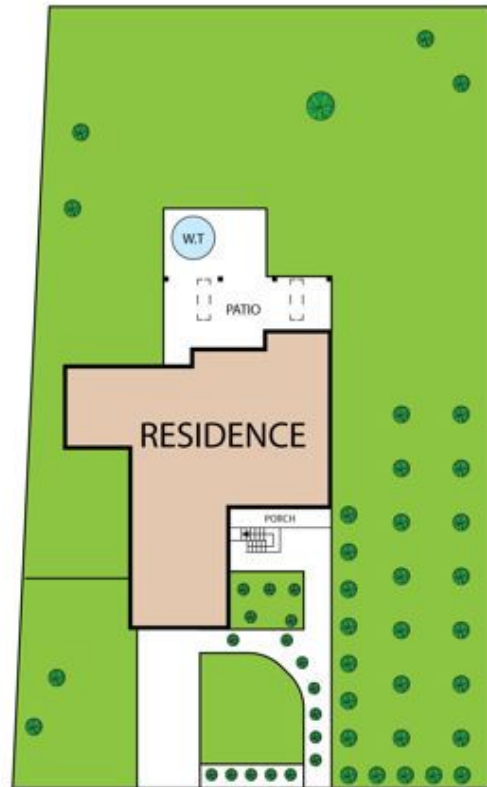

10 Anzac Avenue, Junee 2663

TOTAL APPROX. FLOOR AREA 164 SQM

Whilst every attempt has been made to ensure the accuracy of the floor plan contained here, measurements of doors, windows, rooms and any other items are approximate and no responsibility is taken for any error, omission, or misstatement. This plan is for illustrative purposes only and should be used as such by any prospective purchaser.