

SOLD



47 Lydia Street, Junee

Built in a desirable elevated position this spacious three-bedroom home has been designed to take full advantage of the floor space over two levels.

The top floor consists of an L shaped living area with floating timber floor boards which flows through to the dining room. This takes you to the kitchen which has a contemporary oven, with a new rangehood and cooktop to be installed.

The bathroom is timeless in style and is situated between two bedrooms with robes. Gas ducted heating and evaporative cooling ensure year round comfort

Downstairs is the third bedroom with personal access and ensuite - perfect for a teenage retreat or extra accommodation for family and friends. The laundry is also located downstairs...

3  2  3 

Price: Undisclosed

View: <https://remaxvision.com.au/7179815>

Jenna Pollard

M 0418 421 621



Jacqui Hedlund
0416 243 257



Narrabeen

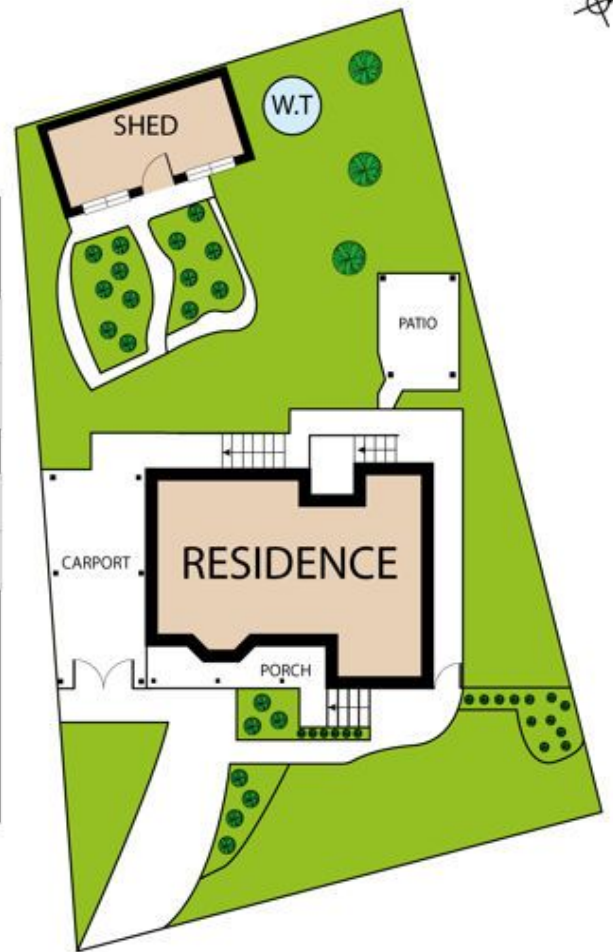
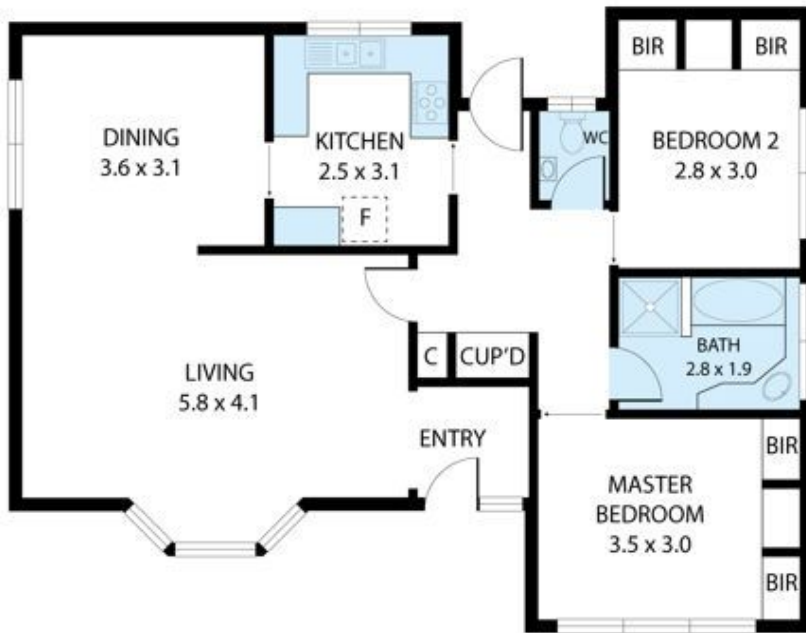

47 Lydia Street, Junee 2663

TOTAL APPROX. FLOOR AREA 103 SQM

Whilst every attempt has been made to ensure the accuracy of the floor plan contained here, measurements of doors, windows, rooms and any other items are approximate and no responsibility is taken for any error, omission, or misstatement. This plan is for illustrative purposes only and should be used as such by any prospective purchaser.