

SOLD



RE/MAX



RE/MAX



RE/MAX



RE/MAX

41 Gloucester Street, Junee

Welcome to 41 Gloucester Street Junee; a well-maintained package defining great value in the current market. With an internal revamp, you will enjoy floating floors through the living zones flowing through to a practical kitchen design with gas cooking, electric oven and generous overhead storage. Enjoy window furnishings along with a wood fire, gas ducted heating and evaporative cooling for year-round comfort Stemming off the central hallway, you will enjoy two spacious bedrooms, one with a wall of robes plus easy access to the main bathroom which features a corner spa, large shower and modern vanity.

...

2 1 2

Price: Undisclosed

View: <https://remaxvision.com.au/7316944>

Emma Heard
M 0431 921 625



Jenna Pollard
0418 421 621



Narrabeen

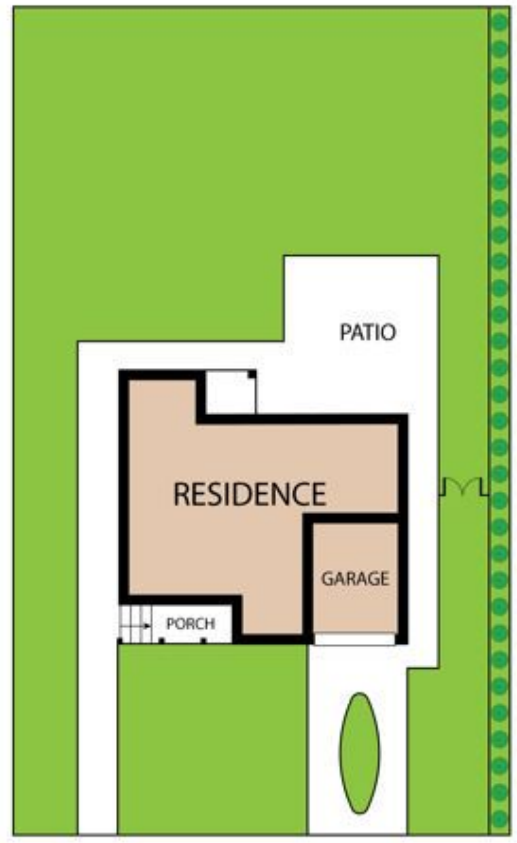

41 Gloucester Street, Junee 2663
TOTAL APPROX. FLOOR AREA 102 SQ.M

Whilst every attempt has been made to ensure the accuracy of the floor plan contained here, measurements of doors, windows, rooms and any other items are approximate and no responsibility is taken for any error, omission, or misstatement. This plan is for illustrative purposes only and should be used as such by any prospective purchaser.