

SOLD**62 Joffre Street, Junee**

Introducing a charming weatherboard cottage at 62 Joffre Street, Junee, nestled within a 1012 square metre land parcel, perfect for families, first home buyers, and savvy investors alike. Recently painted exteriors, white picket fence, and timber windows lend a timeless appeal to this quaint abode, which is ideally situated just a short stroll away from the town centre, schools, and other essential amenities.

The inviting interiors feature two generously sized bedrooms, one with a dressing room, complemented by ducted gas heating and evaporative cooling systems for year-round comfort. The lounge room is accentuated by a sunlit office/sunroom on the northern side, ensuring ample space for work and leisure. A combined dining area seamlessly integrates with the laminate kitchen, equipped with a dishwasher and a space-saving European laundry....

A contemporary bathroom with a shower over bath adds a touch of luxury to this cosy haven. The property boas...

2 1 4

Price: Undisclosed**View:** <https://remaxvision.com.au/7617214>**Jacqui Hedlund****M 0416 243 257****Jenna Pollard**
0418 421 621

Narrabeen

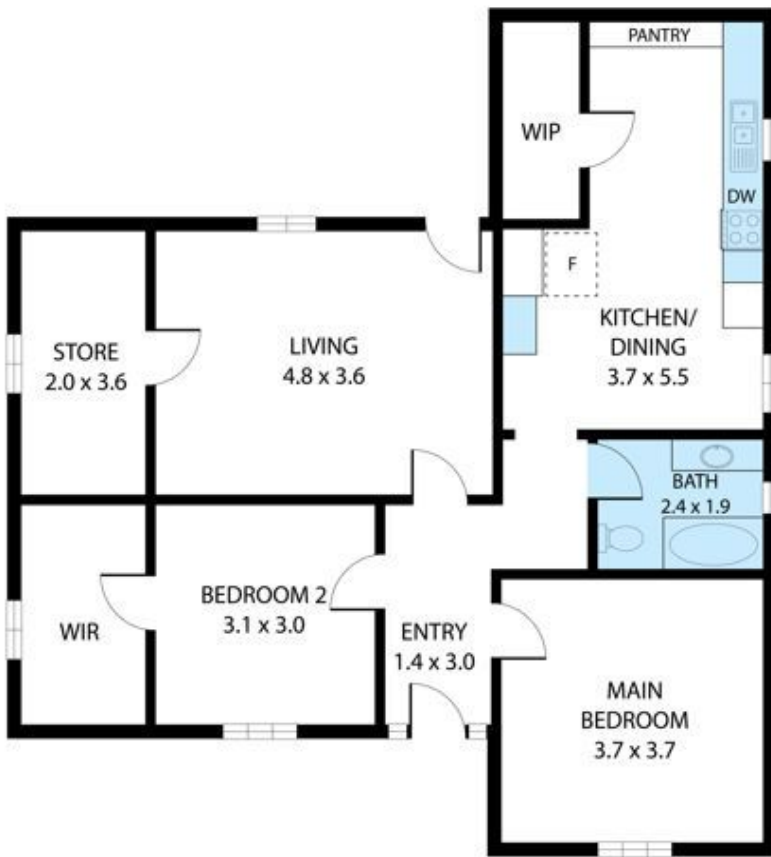

62 Joffre Street, Junee 2663
TOTAL APPROX. FLOOR AREA 90 SQ.M

Whilst every attempt has been made to ensure the accuracy of the floor plan contained here, measurements of doors, windows, rooms and any other items are approximate and no responsibility is taken for any error, omission, or misstatement. This plan is for illustrative purposes only and should be used as such by any prospective purchaser.