

SOLD



### 30 Hammond Street, Junee

Invest in your future with this exceptional property at 30 Hammond, JUNEE, NSW, 2663. This well-maintained, 3-bedroom house is situated on a generous 954m2 flat residential block, boasting a long-term tenant since 2016. With a lease running until April 2024 and a consistent weekly rent of \$275.00, it's an investor's dream.

This property offers segregated yard space, rear lane access, perimeter fencing and proximity to picturesque parkland. It features a spacious carport and handy garden shed. Two comfortable bedrooms are situated at the front of the property, with the master boasting built-in robes and a Samsung split system.

...

3  1  1 

**Price:** Undisclosed

**View:** <https://remaxvision.com.au/7628049>

**Jenna Pollard**  
M 0418 421 621



**Jacqui Hedlund**  
0416 243 257



Narrabeen

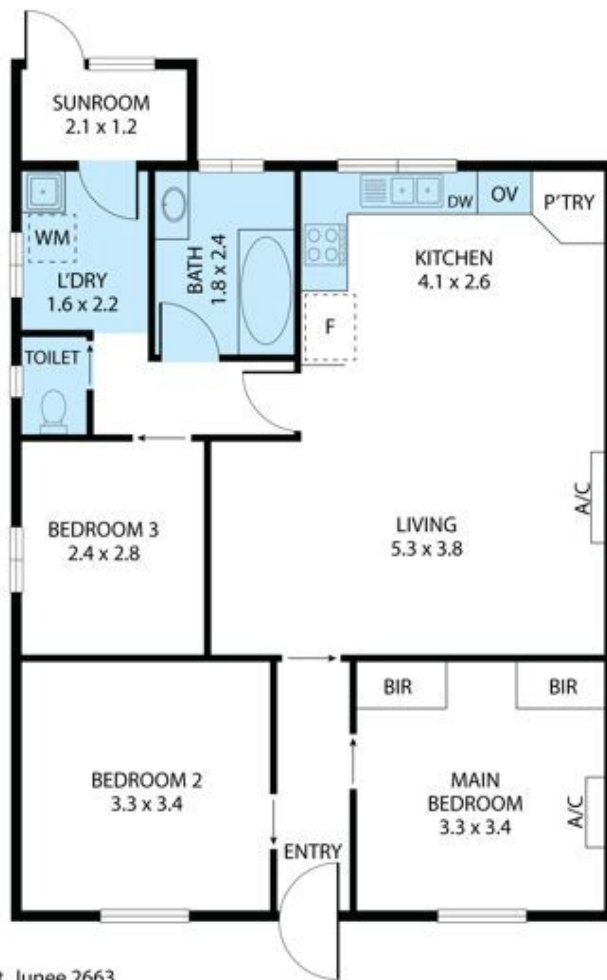

30 Hammond Street, Junee 2663

TOTAL APPROX. FLOOR AREA 79 SQ.M

Whilst every attempt has been made to ensure the accuracy of the floor plan contained here, measurements of doors, windows, rooms and any other items are approximate and no responsibility is taken for any error, omission, or misstatement. This plan is for illustrative purposes only and should be used as such by any prospective purchaser.