

FOR SALE



27 John Potts Drive, Junee

Introducing an idyllic family haven at 27 John Potts Drive, Junee. This splendid four-bedroom, two-bathroom modern house is perfect for those seeking a beautiful home in a highly sought-after location. Set amidst the serenity of established trees and boasting a land size of 1046 square metres, this property is situated in a charming, family-friendly area. Experience unparalleled comfort and convenience with a host of features, including gas ducted heating, evaporative cooling, reverse cycle split system, tinted front windows and insulated underfloor. The versatile split-level living area offers a formal lounge room and an open-plan kitchen, dining and family zone, catering to all your entertaining needs....

...

4 2 4

Price: \$725,000

View: <https://remaxvision.com.au/7818702>

Jenna Pollard
M 0418 421 621



Jacqui Hedlund
0416 243 257



Narrabeen

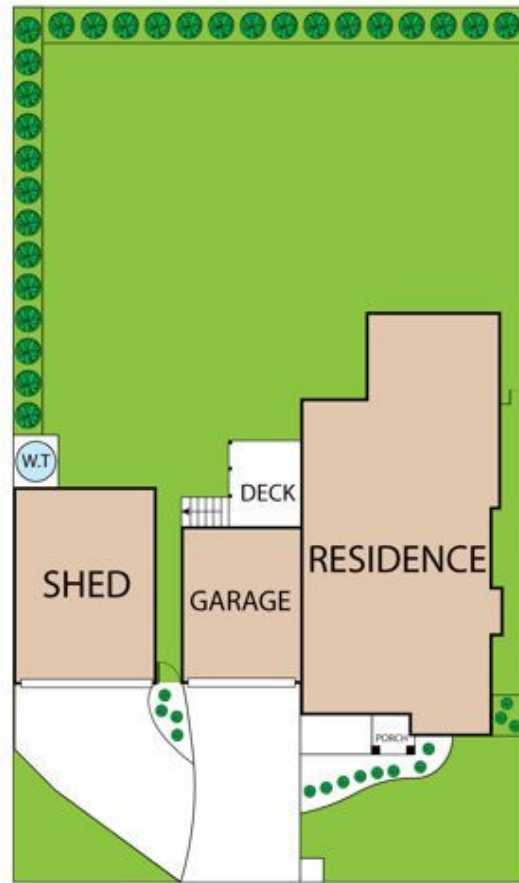

27 John Potts Drive, Junee 2663

TOTAL APPROX. FLOOR AREA 154 SQ.M

Whilst every attempt has been made to ensure the accuracy of the floor plan contained here, measurements of doors, windows, rooms and any other items are approximate and no responsibility is taken for any error, omission, or misstatement. This plan is for illustrative purposes only and should be used as such by any prospective purchaser.