

FOR SALE



32 Belmore Street, Junee

Introducing a truly exquisite and visually stunning family residence, situated at 32 Belmore Street, Junee. This traditional-style home is the epitome of sophistication and style, providing the perfect blend of security and quality of living in a central and highly sought-after location. The impressive lead light windows enhance the show-stopping appeal of this modernised period home, which boasts three large bedrooms, including a master suite with additional study. The high pressed metal ceilings, ornate cornices, and charming leadlight windows and lovingly restored cypress floors create a sense of grandeur as you step inside.

...

3  3  4 
Price: \$745,000 - \$765,000

View: <https://remaxvision.com.au/7864541>
Jacqui Hedlund
M 0416 243 257

Jenna Pollard
0418 421 621

Narrabeen

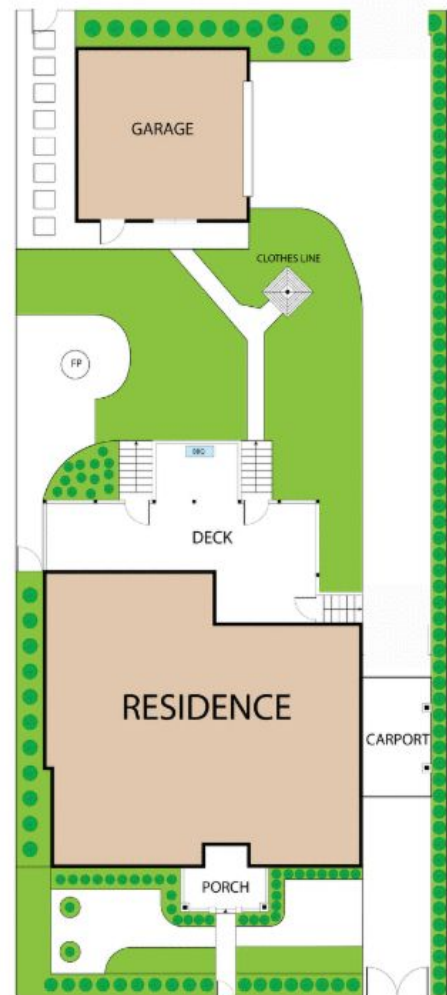

32 Belmore Street, Junee 2663
TOTAL APPROX. FLOOR AREA 176 SQ.M

Whilst every attempt has been made to ensure the accuracy of the floor plan contained here, measurements of doors, windows, rooms and any other items are approximate and no responsibility is taken for any error, omission, or misstatement. This plan is for illustrative purposes only and should be used as such by any prospective purchaser.