

SOLD



**50 Regent Street, Junee**

Nestled on a corner block, this property presents with charm combined with modern conveniences and is the perfect abode for families, first home buyers, or retirees seeking a serene yet connected lifestyle. This delightful three-bedroom, two-bathroom cottage-inspired house is poised on a generous 1012 square metre corner block, offering ample space for outdoor pursuits.

The residence has been thoughtfully rewired and replumbed to meet contemporary standards. The heart of this home is the inviting kitchen, equipped with a 5 burner freestanding cooktop, Fisher & Paykel dishwasher, and a vast walk-in pantry with shelving and sink. The space is further enhanced by extensive cabinetry and an expansive island bench, perfect for family gatherings...

Adjacent to the kitchen lies an open living zone, leading into a formal lounge room adorned with a cosy wood fire, setting the stage f...

3 2 4

**Price:** Undisclosed

**View:** <https://remaxvision.com.au/7895365>

**Jenna Pollard**  
M 0418 421 621



**Jacqui Hedlund**  
0416 243 257



Narrabeen

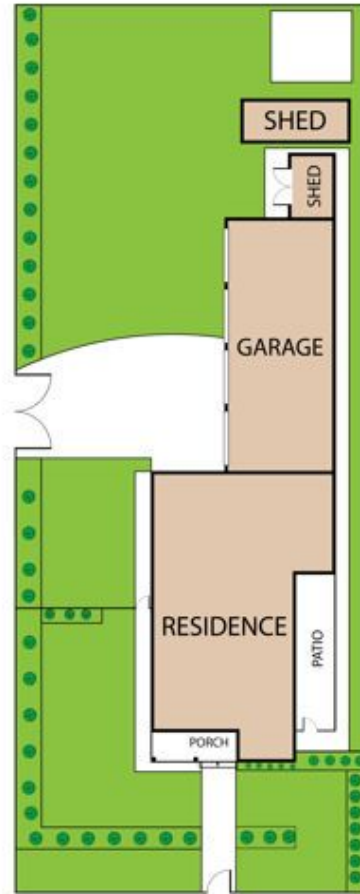

50 Regent Street, Junee 2663  
TOTAL APPROX. FLOOR AREA 197 SQ.M

Whilst every attempt has been made to ensure the accuracy of the floor plan contained here, measurements of doors, windows, rooms and any other items are approximate and no responsibility is taken for any error, omission, or misstatement. This plan is for illustrative purposes only and should be used as such by any prospective purchaser.