

LEASED



2/84 John Potts Drive, Junee

This delightful three-bedroom unit presents a perfect opportunity for renters seeking a harmonious blend of comfort and convenience. This brand new build is a stone's throw from local amenities, offering a serene lifestyle without compromising on accessibility in a sought after area. This home welcomes you with an open plan layout encompassing a well-appointed kitchen, living, and dining area, designed for effortless entertaining and relaxation. The kitchen is equipped with a sleek Smeg dishwasher, a 4-burner cooktop, and a butler's pantry that will impress any culinary enthusiast. The master bedroom serves as a private retreat, complete with an ensuite and a walk-in robe...

3 2 2

Price: \$450 Weekly
View: <https://remaxvision.com.au/8075896>

Aimee Hanson
M 0418583510



RE/MAX Property Specialits,
Narrabeen

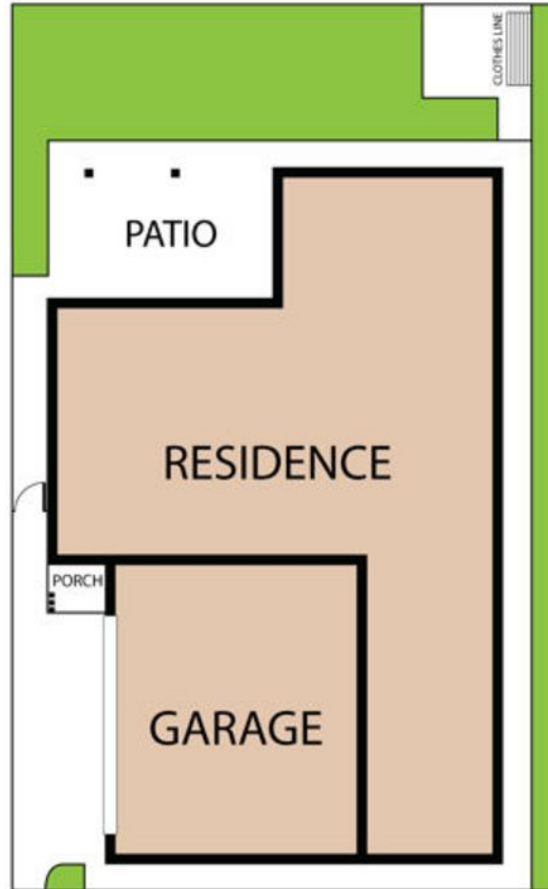

2/84 John Potts Drive, Junee 2663

TOTAL APPROX. FLOOR AREA 171 SQ.M

Whilst every attempt has been made to ensure the accuracy of the floor plan contained here, measurements of doors, windows, rooms and any other items are approximate and no responsibility is taken for any error, omission, or misstatement. This plan is for illustrative purposes only and should be used as such by any prospective purchaser.