

FOR SALE



RE/MAX



RE/MAX



RE/MAX



RE/MAX

48 Prince Street, Junee

Discover a home that caters to the comfort and style of modern family living. Perfect for first-time buyers or growing families, this delightful three-bedroom, two-bathroom house offers an exceptional blend of functional design and contemporary finishes. The residence greets you with luscious hedges that ensure privacy, creating a tranquil space to savour your morning coffee on the expansive front verandah. Upon entry, one is greeted with elegant stone flooring that leads to a warm, timber-look vinyl corridor, inviting you towards the serene sleeping quarters. The master bedroom is a plush retreat, boasting soft carpeting, a built-in robe, a ceiling fan for comfort, and a private ensuite equipped with all the essentials....

Two additional bedrooms, both with carpet and built-in robes, ensure ample space for family and guests alike. The front formal lounge with its modern carpet, flows effortlessly into a vast open plan living and dining area. This heart of the home is adorned with a Fujitsu split system, downlights, a ceiling fan, and a w...

3 **2** **1**

Price: \$530,000

View: <https://remaxvision.com.au/8261851>

Jacqui Hedlund
M 0416243257



Jenna Raulston
0418 421 621



Narrabeen

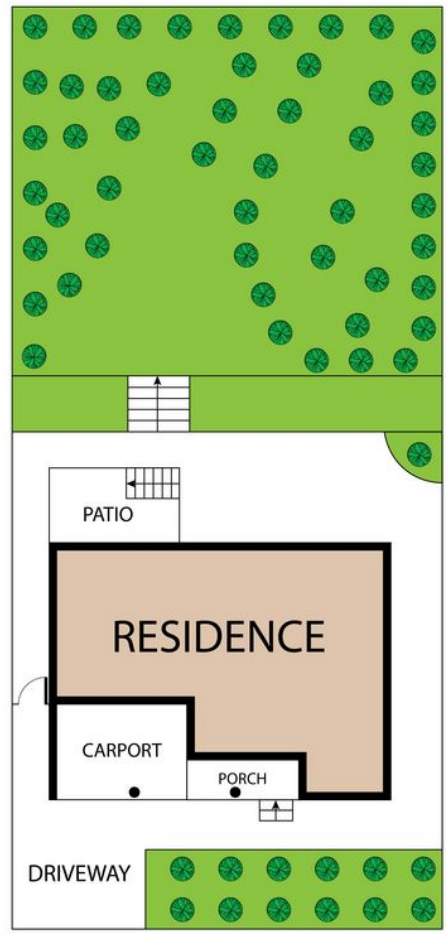
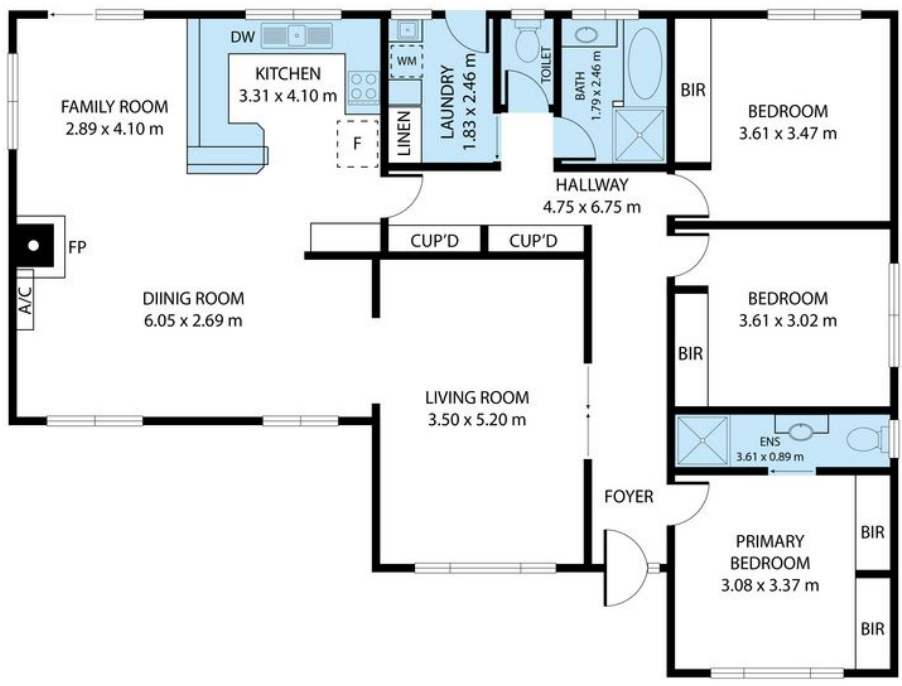

48 Prince Street, Junee, NSW, 2663

TOTAL APPROX. FLOOR AREA 123 SQ.M

Whilst every attempt has been made to ensure the accuracy of the floor plan contained here, measurements of doors, windows, rooms and any other items are approximate and no responsibility is taken for any error, omission, or misstatement. This plan is for illustrative purposes only and should be used as such by any prospective purchaser.